

Product Data Sheet

P3300T10 Channel (Slotted)

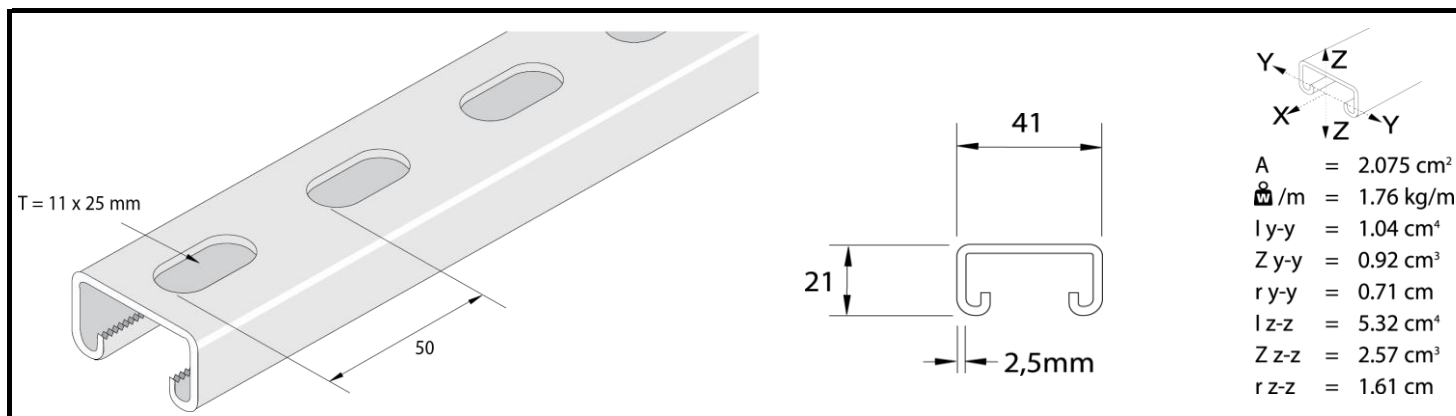

L(mm)	F		f=1/200L	f=1/360L	F(kN)	F(kN)
	Fmax(kN)	fmax(mm)				
250	5.152	0.49	-	-	-	-
500	2.576	1.97	-	1.819	-	-
750	1.717	4.42	1.455	0.809	-	-
1000	1.288	7.87	0.819	0.455	-	-
1250	1.030	12.29	0.524	0.291	-	-
1500	0.859	17.70	0.364	-	-	-
1750	0.736	24.09	0.267	-	-	-
2000	0.644	31.46	-	-	-	-

NOTES:

1. The allowable loads shown above are shown for simple spans, i.e. beam on two supports with adequate lateral support.
2. Above loads include the weight of the member, this weight should be deducted to arrive at the net allowable load the beam will support.

NB: Load data is for **Mild Steel** channels

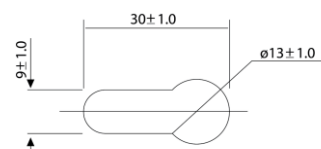

*Alternative Key Slot Available

Material:

- P3300TP:- Plain Coil to BS EN 10025 Pickled & Oiled min. yield 280 n/mm²
- P3300TPG:- Mild steel - BS EN 10346 1.0244
- P3300TH:- Plain Coil to BS EN 10025 Pickled & Oiled min. yield 280 n/mm²
- P3300TDH:- BS EN 10025 S275JO+AR+CL1 or equivalent/better.
- P3300TSS:- Stainless Steel Coil Hot Rolled to B.S.EN10088-2-1.4404+1D

Finishes:

- P3300TP:- Self Colour
- P3300TPG:- BS EN 10346 coating Z275
- P3300TH:- Hot Dip Galvanized - to BS EN ISO 1461: to a mean coating thickness (minimum) of 55 µm.
- P3300TDH:- Hot Dip Galvanized - to BS EN ISO 1461: to a mean coating thickness (minimum) of 85 µm.
110 µm available upon request
- P3300TSS:- Self Colour